

100
0 10
A1

DO NOT SCALE

File: 5154251_LWC_DR_0500.dwg
Date: Oct 31, 2019 - 2:16pm
Plotted by: patrick.sheridan

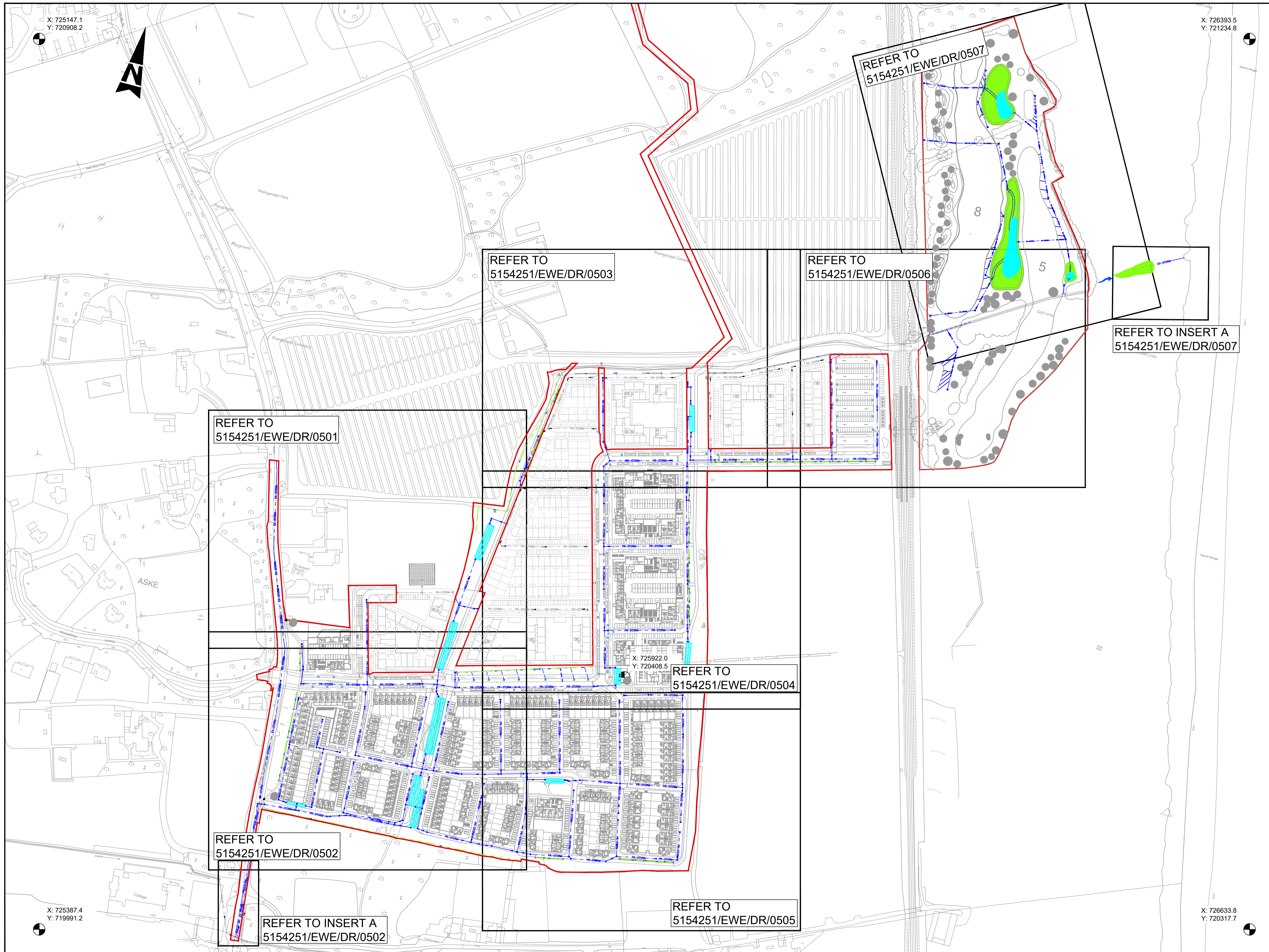

- GENERAL NOTES**
1. ALL DIMENSIONS ARE IN MILLIMETRES UNLESS NOTED OTHERWISE
 2. ONLY WRITTEN DIMENSIONS SHALL BE USED. NO DIMENSIONS SHALL BE SCALED FROM THE DRAWINGS
 3. ALL LEVELS ARE IN METRES AND ARE TO MALIN HEAD DATUM
 4. ALL COORDINATES ARE IN METRES AND ARE TO IRISH TRANSVERSE MERCATOR
 5. DRAWINGS ARE TO BE READ IN CONJUNCTION WITH THE SPECIFICATION

LEGEND:
 — SITE BOUNDARY
 OS SHEET REFERENCES
 3518-12, 3518-13, 3518-17, 3518-18
 3518-22, 3518-23, 3568-02, 3568-03

Rev	Description	By	Date	Chk'd	Auth
-	FOR PLANNING	PS	18.10.19	AC	GH
-	FINAL CLIENT APPROVAL	PS	09.10.19	AC	GH

ATKINS
 Member of the SNC-Lavalin Group

Atkins House, 150-155 Airside
 Business Park, Swords, Co. Dublin
 Tel (+353) 01 810 8000
 Fax (+353) 01 810 8001

Unit 2B, 2200 Cork Airport
 Business Park, Cork
 Tel (+353) 021 429 0300
 Fax (+353) 021 429 0360

2nd Floor Technology House
 Parkmore Technology Park, Galway
 Tel (+353) 091 786 050
 Fax (+353) 091 779 830

Client: **AEVAL**

Project: **WOODBROOK PHASE 1**

Purpose: PLANNING		Title: PROPOSED STORM WATER LAYOUTS KEY PLAN	
Original Scale 1:2000 at A1 1:4000 at A3	Design/Drawn PS Date 16.05.19	Checked AC Date 16.05.19	Authorised GH Date 16.05.19
Status P	Drawing Number 5154251 / EWE / DR / 0500	Rev -	